

HOLDING NO. 30, KANAILAL GOSWAMI SARANI, UNDER CIRCLE NO. 'F', OF THE SERAMPORE MUNICIPALITY COMPRISED IN L.R. DAG NOS. 2575, 2577, 2584, 2586, 2587, 2590, 2591, 2592, 2593, 2594, 2595, 2596, 2597, 2598, 2599, 2600, 2601, 2602, MOUZA: MAHESH, P.S. SERAMPORE, J.L.: 15, L.R. KHATIAN NO. 11337, P.O. SERAMPORE, PIN: 712201, DISTRICT HOOGHLY, WEST BENGAL.

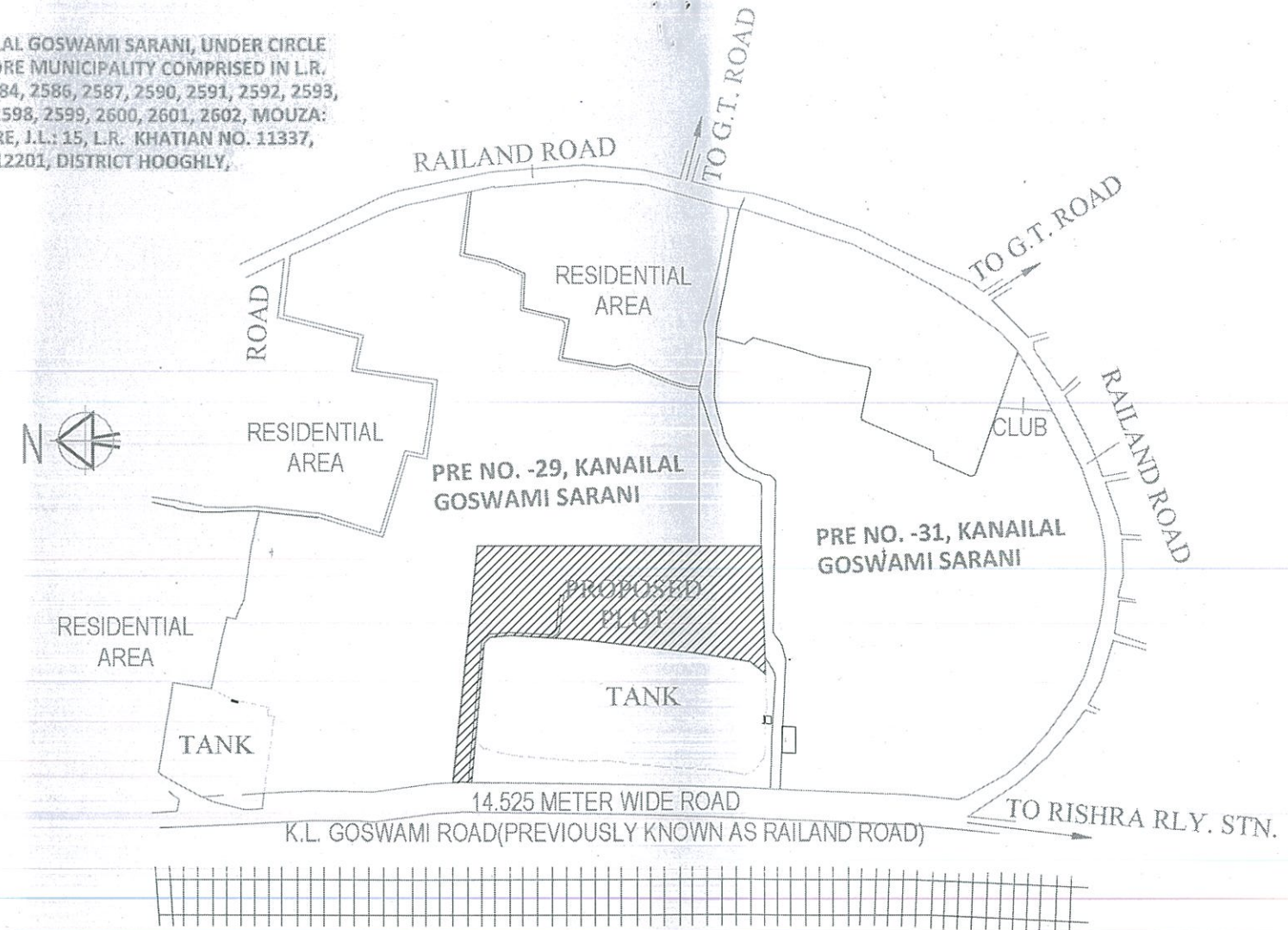

LOCATION PLAN

SCALE :- 1:4000

EDEN INFRABUILD PVT LTD.

Kumar Setyal

Director

LAT : 22° 44' 16.28" N

LONG : 88° 20' 43.04" E